

***REGLEMENTARI EDILITARE**



-  CENTRALA TERMICA EXISTENTA
-  CONDUCTA DISTRIBUTIE GAZ PRESIUNE REDUSA EXISTENTA
-  STALPURI LEA 0.4 kV EXISTENTE
-  LEA 0.4kV EXISTENT
-  LES 1kV EXISTENT
-  CAMINE DE VIZITATRE APA POTABILA EXISTENTE
-  CONDUCTA DE APA POTABILA EXISTENTA
-  CAMINE DE VIZITATRE CANALIZARE MENAJERA EXISTENTE
-  CANAL MENAJER EXISTENT

PUD PLAN URBANISTIC DE DETALIU
ETAJARE SPATIU COMERCIAL
COMPLEX "DACIA"
TG. MURES, str. BRASOVULUI, nr. 2
5) reglementari edilitare

LEGENDA

-  LIMITA ZONEI STUDIASTE
-  LIMITA INCINTA COMPLEX DACIA conf. HGR 834/91
-  LIMITA SPATIU COMERCIAL PROPUS PT. ETAJARE (136,0 mp)
-  SUPRAFATA SUB COPERTINA (fascie 1,45 m, total 89,0 mp)
-  STRAZI LOCALE ASFALTATE, PLATFORME CAROSABILE, PARCAJE
-  TROTUARE SI ALEI PIETONALE
-  CURTE INTERIOARA AFERENTA INCINTEI COMPLEX DACIA
-  CANALUL POCLOS
-  CONSTRUCTII EXISTENTE

***REGLEMENTARI PROPUSE**

-  SPATIU COMERCIAL PROPUS PENTRU ETAJARE
-  SCARI PROPUSE (1,45m x 0,9m)

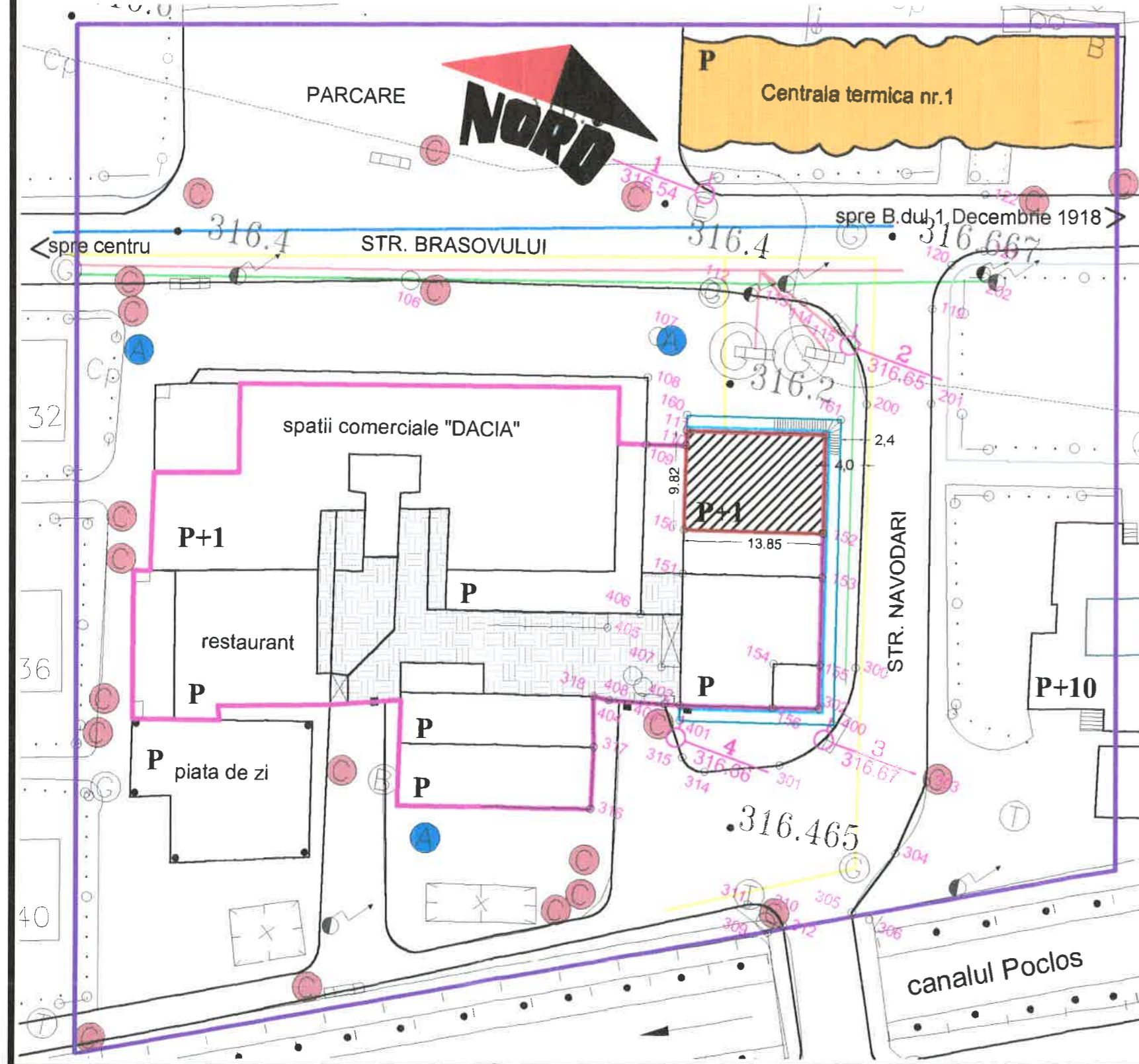

S.C. "PROIECT" S.R.L. TG. MURES J26-621-1991			Beneficiar: JOZSA KAMILLA EDINA TG. MURES, str. BUCEGI nr. 5	Pr.nr. 184.0/2010
Director cons. Jr. Simb I.	Sc: 1:500		PUD - ETAJARE SPATIU COMERCIAL COMPLEX "DACIA" TG. MURES, str. BRASOVULUI, nr. 2	Faza PUD
Sef proiect arh. Keresztes G.	DATA 2010			
Desenat teh. Gyereal M.				