

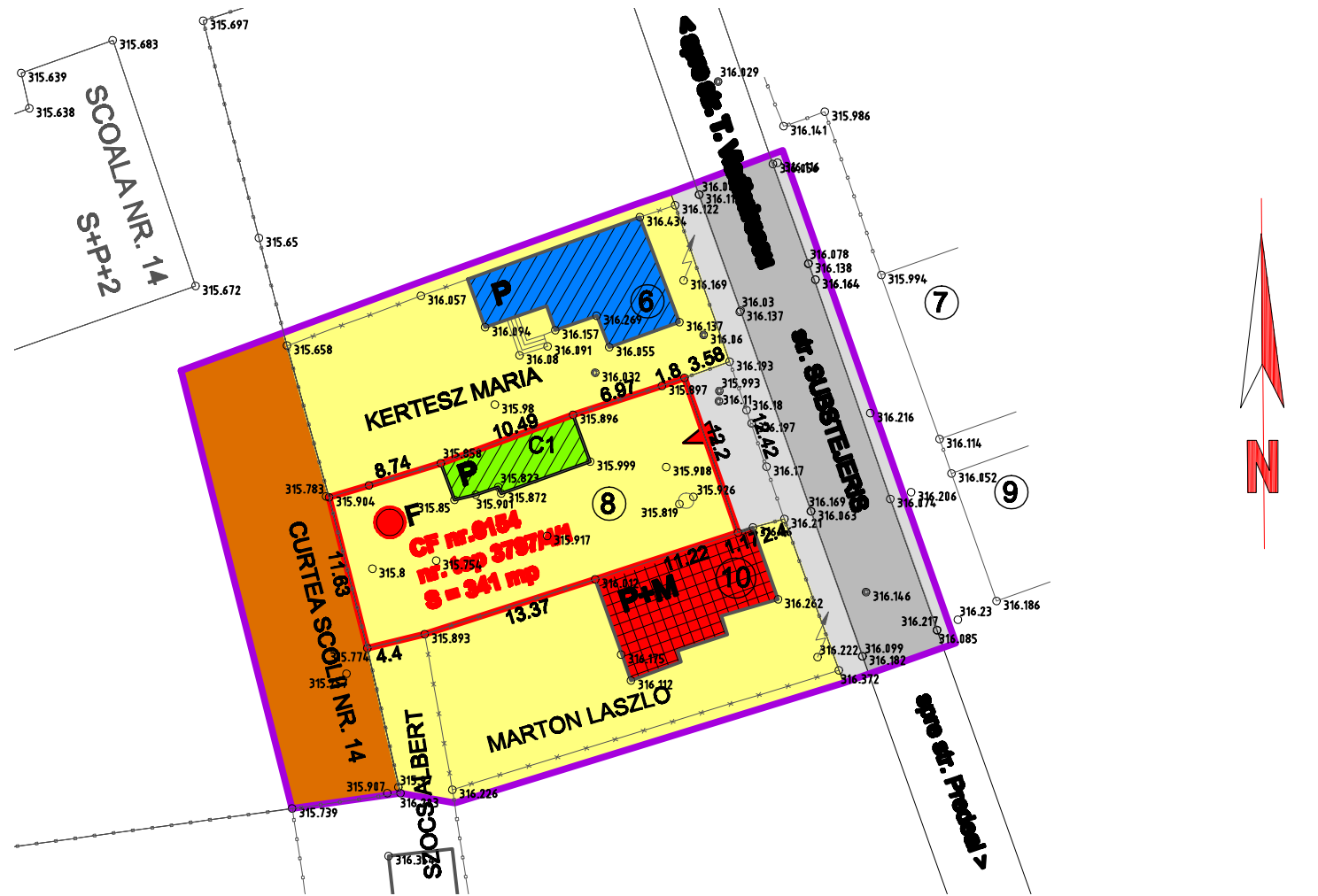







PUD PLAN URBANISTIC DE DETALIU

STUDIU DE AMPLASAMENT
CONSTRUIRE CASA DE LOCUIT P+M
Tg. Mureș, str. Substejeris nr.8

2) situația existentă



LEGENDA

-  LIMITA ZONEI STUDIATE
-  LIMITA PROPRIETATE STUDIATA (341,0 mp)
-  ZONA DE LOCUIT EXISTENT
-  ZONA INSTITUTII (curtea școlii)
-  STR. SUDSTEJERIS EXISTENT
-  ACCES EXISTENT
-  F FORAJ EXECUTAT

*CONSTRUCTII EXISTENTE IN ZONA STUDIATA

FUNCTIUNEA

 CASE DE LOCUIT

STAREA

 BUNA

 MEDIOCRA

 REA

STRUCTURA

 MATERIALE DURABILE

 MATERIALE SEMIDURABILE

REGIM DE CONSTRUIRE

 P - P+M PARTER - PARTER+MANSARDA

*CONSTRUCTII EXISTENTE IN INCINTA STUDIATA

C1 - Casa de locuit necorespunzatoare ca functie, structura, fara confort, propus pentru demolare

S.C. "PROIECT" S.R.L.			Beneficiar: Todoran Emilia G. Cristian <i>si sotul Todoran Emilia Anamaria</i> Tg. Mureș, str. Substejeris nr.8		Pr.nr. 684.0/2012
Director	cons. jr. Simó I.		Sc:	PUD - STUDIU DE AMPLASAMENT CONSTRUIRE CASA DE LOCUIT P+M Tg. Mureș, str. Substejeris nr.8	Plan PUD
Sef proiect	arh. Keresztes G.		1:500		
Desenat	teh. Gyeresi M.		DATA 2012		
SITUATIA EXISTENTA					Pl.nr.2