

PLAN URBANISTIC ZONAL

**STABILIRE REGLEMENTARI PENTRU CONSTRUIRE
CASA DE LOCUIT si AMENAJARE ACCES
str. REMETEA (IOAN VESCAN) fn TG.MURES**



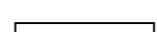

SITUATIA EXISTENTA

LEGENDA

LIMITE

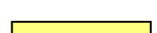
- Rosu 8  LIMITA INTRAVILAN
-  LIMITA ZONEI STUDIATE
-  LIMITA DE PROPRIETATE

ZONIFICARE FUNCTIONALA

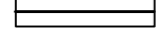
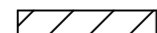
- Galben 3  ZONA DE LOCUIT - REGIM DE INALTIME MIC
- Galben 2  ZONA TEREN AGRICOL INTRAVILAN
- Violet 10  ZONA CAI DE COMUNICATIE RUTIERA
-  STRAZI CU IMBRACAMINTE PROVIZORIE - PAMANT
-  ZONA CU INTERDICTIE DE CONSTRUIRE PANA LA APROBAREA DOC. DE URBANISM
-  CANAL DESECARE

DISFUNCTIONALITATE

- DRUM DE ACCES LA NOILE DEZVOLTARI - DRUM DE CAMP

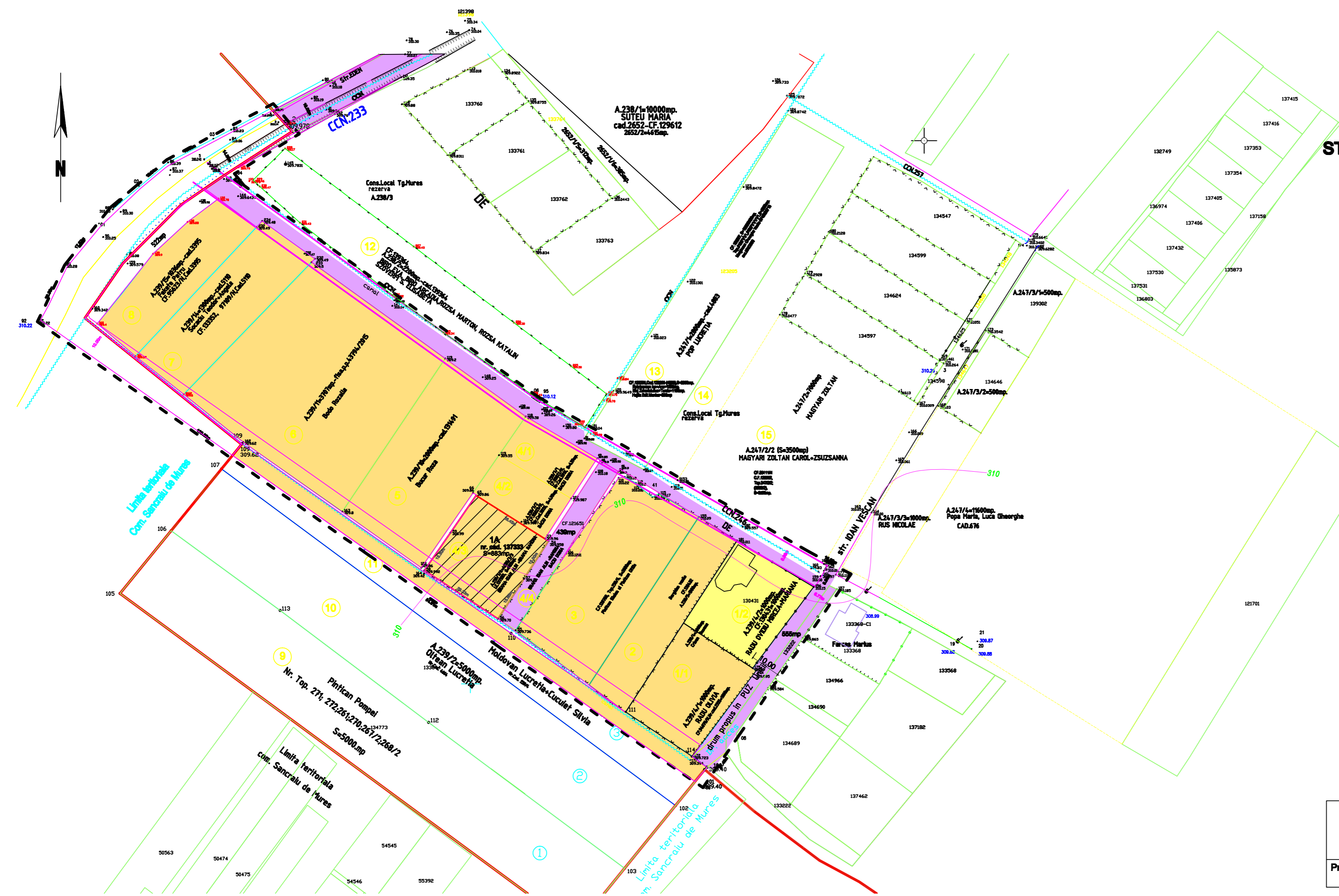

sc VIA MODUL arl C.U.I. 14357551 J26 / 900 / 2001 TG.MURES	PLAN URBANISTIC ZONAL STABILIRE REGLEMENTARI PENTRU CONSTRUIRE CASA DE LOCUIT si AMENAJARE ACCES str. REMETEA (IOAN VESCAN) fn TG.MURES		PR.NR. 758 tr. IV 2019
	BENEFICIARI - GRAMA IOAN ALIN si RAMONA		
Pr. arh. MARIA DRAGOTA TNA nr. 515	SITUATIA EXISTENTA SC. 1:1000	FAZA PUZ PL. A/1	