

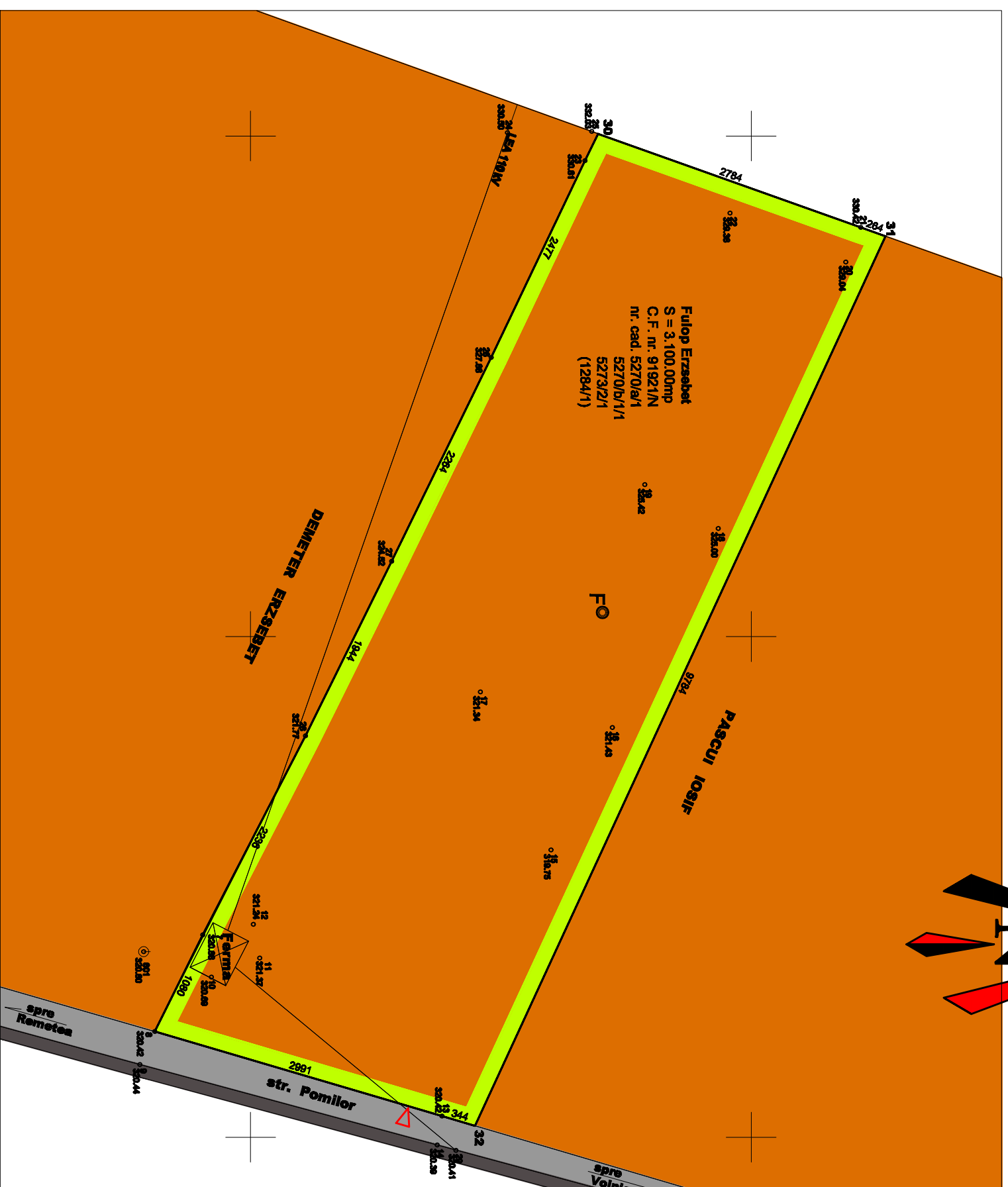

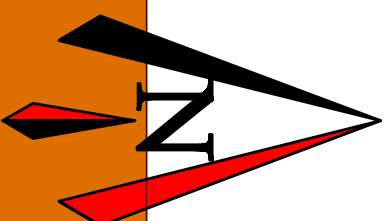



**PLAN URBANISTIC DE DETALIU
CONSTRUIRE CASA DE LOCUIT P+M
str. Pomilor F.N., mun. Targu Mures
A.3. SITUATIA EXISTENTA**

Scara 1 : 500



LEGENDA

-  **Limita zonei studiate**
-  **Teren agricol in intravilan**
-  **Aleii pietonale, trotuare - existente**
-  **Drumuri, strazi - existente**
-  **Acces carosabil - existent**
-  **Foraje geotehnice**

S.C. ARHIEDIL S.R.L. Tirgu Mures		Beneficiar:	Fulop Erzebet	Pt. Nr.	178
Director	Ing. Serban Sorina	Scara:	1:500	Faza:	P.U.D.
Sef proiect	an. Karaszas Geza	CONSTRUIRE CASA DE LOCUIT P + M str. Pomilor F.N., mun. Targu Mures		SITUATIA EXISTENTA	
Proiectat	an. Karaszas Geza				
Desenat	Pozna Laszlo	Data:	Feb. 2009	Plansa: A. 03.	